

LEGEND

- A** - Inspection area.
- B** - Output for the power supply cable type H05 3x2.5mm² length M.2.
- B1** - Output for the equipotential cable
- C** - Draining area
- D** - Ø 50 floor drain.

NOTE:

Do not prepare the power cable for baths with frame.

Prepare the equipotential cable in all cases.

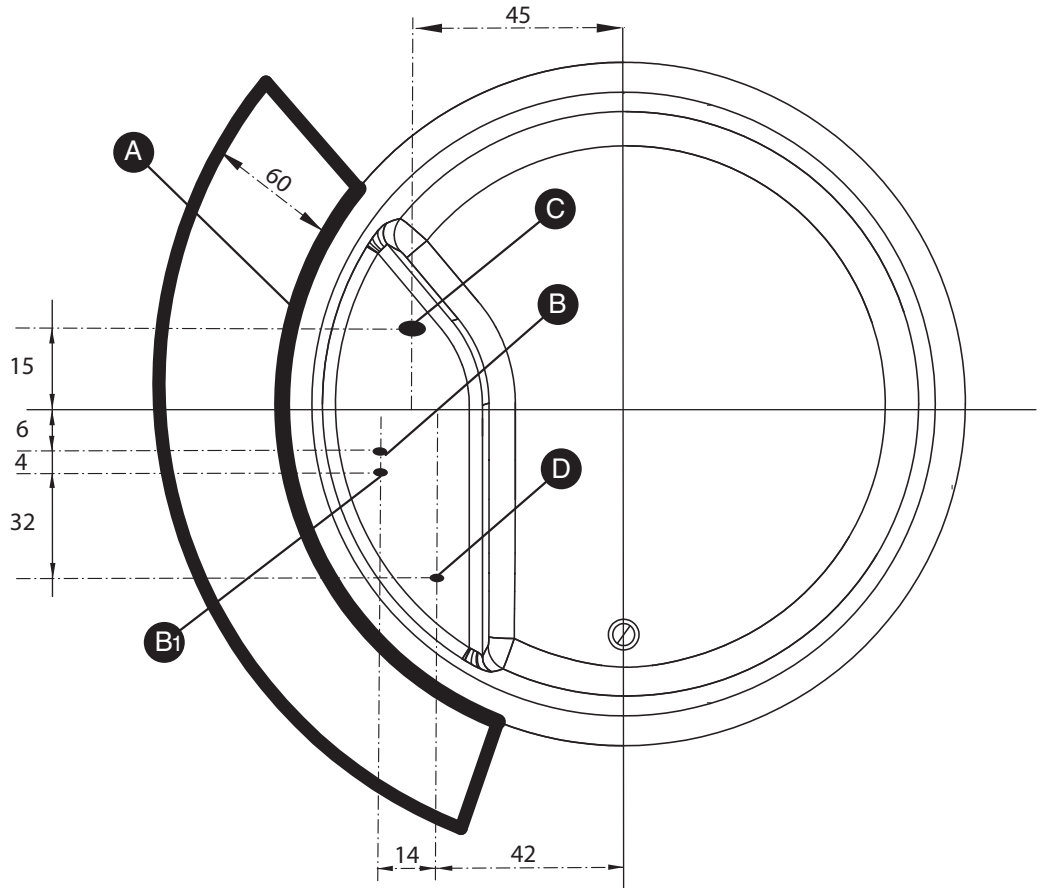

POSITIONING THE TURNING ON CONTROLS AND TAPS WHIRPOOL DIGITALE - WHIRPOOL AIRPOOL

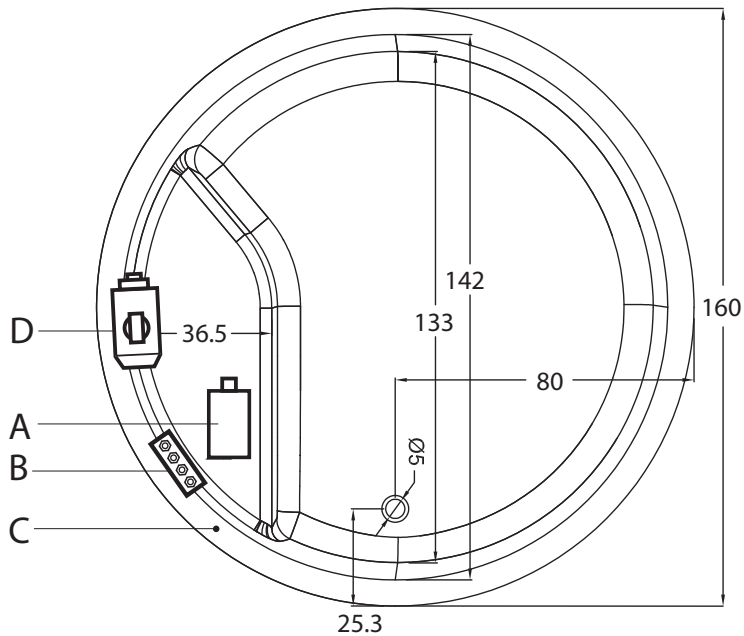

- A = Blower**
- B = Eletronic unit**
- C = Keyboard**
- D = Pump**

A - B - C - D Position can be different according with accessories presence (radio - chromoterapy - heater).

